

GARDEN AREA D

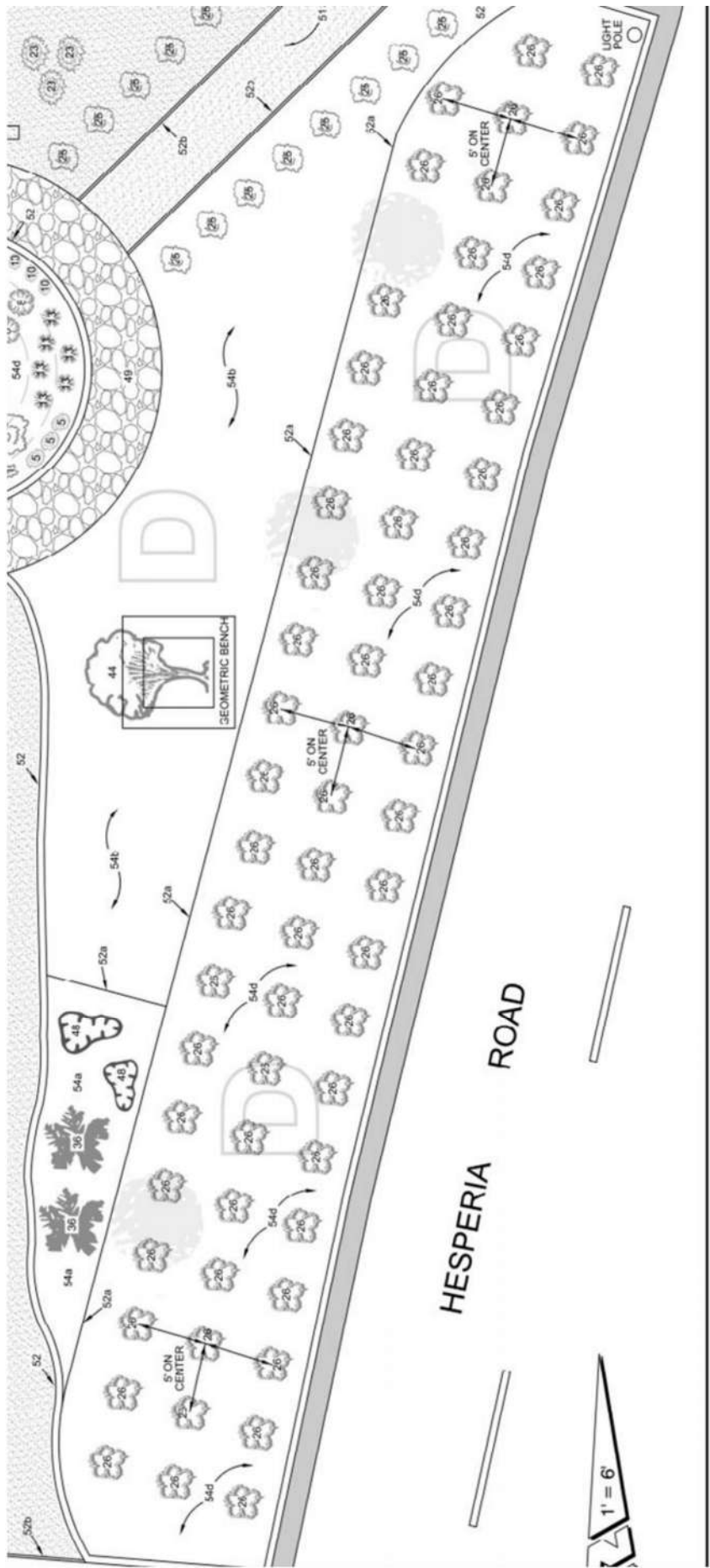
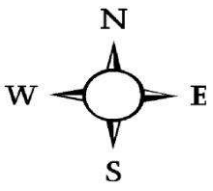

D GARDEN AREA-Ground Covers for Slopes

Planting Area:2467 SQ FT

| PLANT DESCRIPTION | | | | | | | |
|-------------------|-----|--|--|-----|-----------------|--------------|-------------|
| TYPE | # | Common | Botanical | Qty | Tall/Wide | Spacing - ft | Water Needs |
| S | 25 | Bush morning Glory | <i>Convolvulus cneorum</i> | 8 | 2 x 3 | 3 | L |
| GC | 26 | Blue Rug Juniper Creeping blue rug | <i>Juniperus Horizontalis'Wiltonii</i> | 32 | 6" x 8'spread | 5' on center | L-M |
| GC | 26 | Blue Chip Juniper Creeping Bar Harbor | <i>Juniperus Horizontalis'Wiltonii</i> | 32 | 12" x 8' spread | 5' on center | L-M |
| S | 36 | Texas Ranger Sage-Rio Bravo | <i>Leucophyllum langmaniae</i> | 2 | 5 x 5 | 3 | L |
| TS | 44 | Chaste tree Monks pepper tree | <i>Vitex agnus castus</i> | 1 | 18' x 15' | | M |
| | 48 | Boulders 4' - 6' | | | | | |
| | 51 | Decomposed granite tinted between pavers and flagstone | | | | | |
| | 52 | Mow Curb | | | | | |
| | 52a | Plastic Landscape edging (bender board) | | | | | |
| | 54a | Rubber Landscape Mulch Chips 3" depth Color: Brown | | | | | |
| | 54b | 1" x 3" depth Wood chips | | | | | |
| | 54d | Compost 3" depth | | | | | |

Legend: S-shrub, P-perennial, GC-ground cover, T-Tree

L-low water, M-Medium Water, O-no water

Demonstration **Garden Area D** - Photo Sheet



26
Juniper Blue Rug-slope



44
Chaste Tree Monks Pepper



36
Texas Ranger Rio Bravo

